

FORM No. 1.

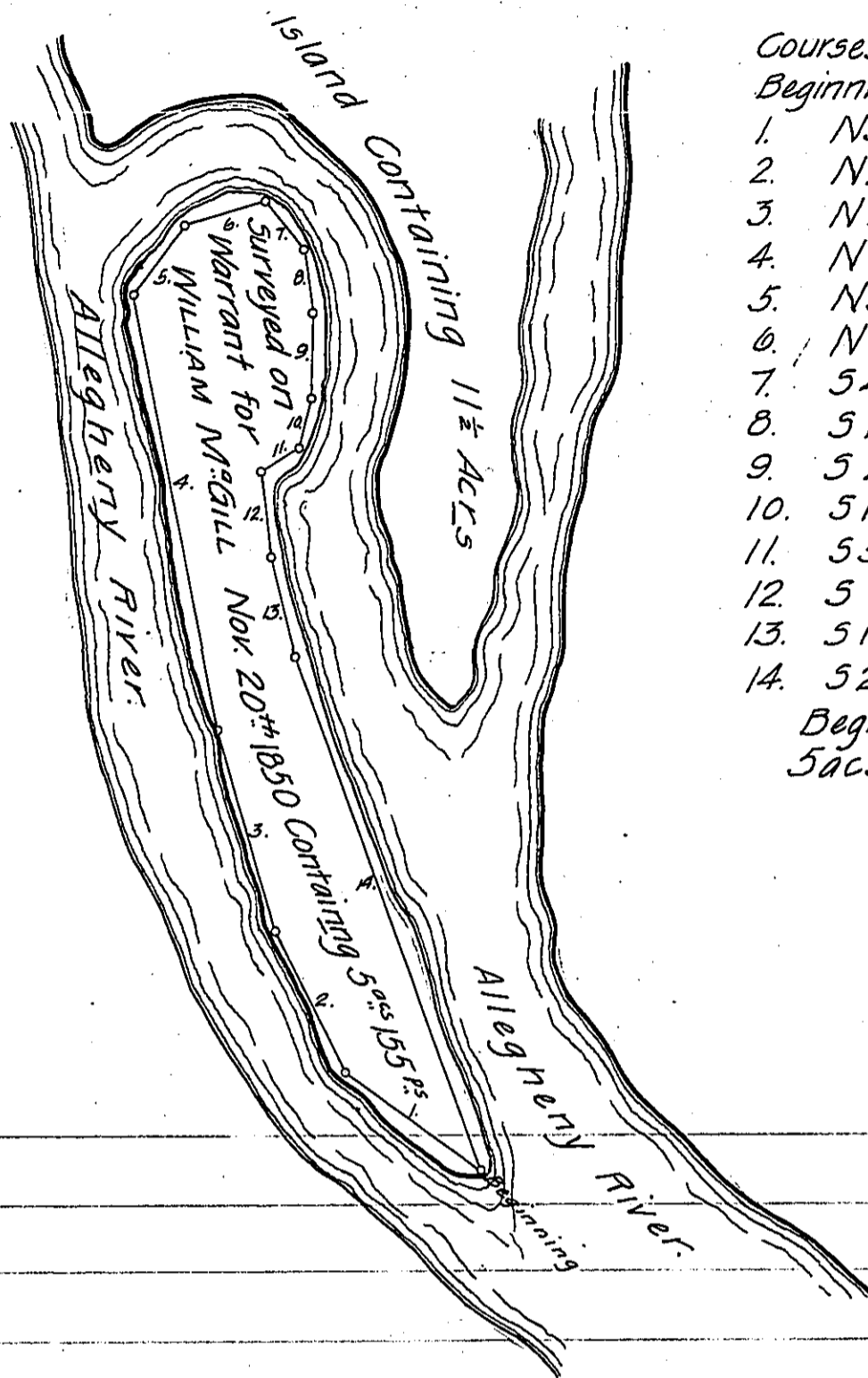

- Courses and distances
Beginning at foot of Island
1. N54°W 16 rods
 2. N28°W 15 "
 3. N17°W 20 "
 4. N12°W 42 "
 5. N35°E 8 "
 6. N69°E 8 "
 7. S40°E 6 "
 8. S10°E 6 "
 9. S2°E 8 "
 10. S14°W 5 "
 11. S56°W 4 "
 12. S7°E 8 "
 13. S16°E 10 "
 14. S21°E 52 to the Beginning. Containig 5acs. 155 perches.

Draft of an Island Situate in the Allegheny River in Limestone town-
ship Warren County and opposite the improvement of W^m M^a Gill. Contain-
ing Five Acres and one hundred and fifty five perches Surveyed the
20th day of November A.D. 1850 for William M^a Gill on a Warrant grant-
ed said W^m M^a Gill dated the 11th day of November 1850.

Witness my
hand this 20th day of November A.D. 1850.

F. H. Ludlow. D.S.

Warren Co.

IN TESTIMONY that the above is a copy of the original remaining on file in
the Department of Internal Affairs of Pennsylvania, made
conformably to an Act of Assembly approved the 16th day of
February, 1833, I have hereunto set my Hand and caused
the Seal of said Department to be affixed at Harrisburg,
this twenty-first day of April 1906.

George A. Dawson
Secretary of Internal Affairs.